

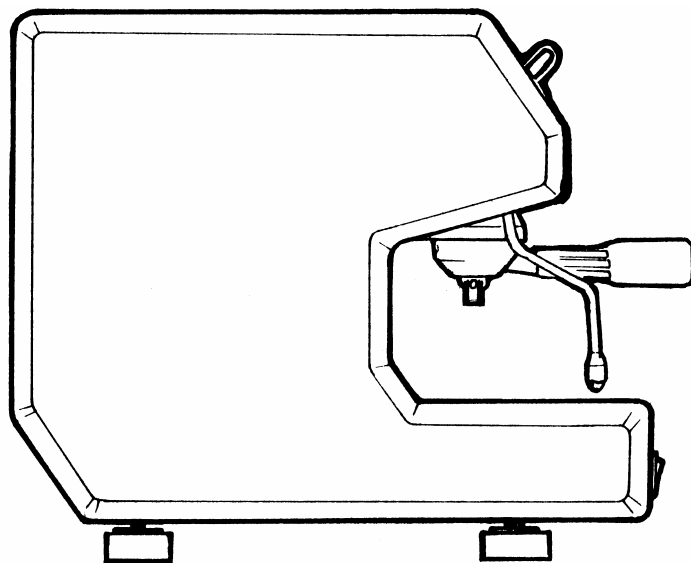

SERVICE MANUAL

Models:

9700000 & 9700014

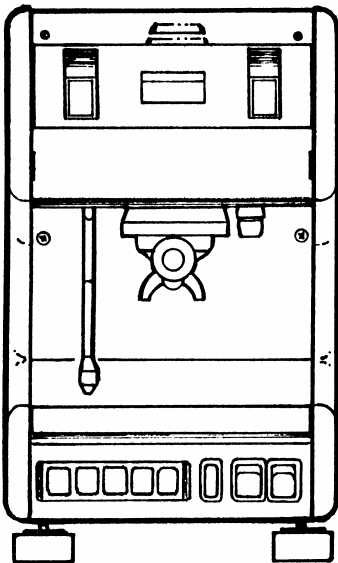

CARIMALI

Uno

Automatic And Semi-Automatic Espresso Machines

Brewmatic Company
3828 S. Main St. Los Angeles, CA 90037
800-421-6860 • 310-787-5444 • Fax 310-787-5412
brewmatic.com

IMPORTANT INFORMATION FOR SERVICE PERSONNEL

Read all instructions and safeguards included in the original packaging, and this service manual, carefully and completely before installing, operating or servicing this appliance. Additional copies of installation instructions and service manuals are available upon request.

The proper performance of service is essential for the safe and effective operation of this appliance. Repairs should be performed by qualified service personnel only. If you are unable to, or need help servicing this appliance, contact the nearest Brewmatic Authorized Service Agent or you can contact Brewmatic Company at 800-421-6860.

Only Authorized Replacement Parts Should Be Used. Part substitutions could create a fire hazard and the risk of personal injury. The use of replacement parts or accessory attachments not recommended by Brewmatic may be hazardous.

Do Not By-Pass Any Safety Mechanisms Or Operate This Appliance Without Covers In Place. Brewmatic requires that all safety devices and covers be in place and functioning at all times to guard against a fire hazard and the risk of personal injury.

Brewmatic Does Not Recommend, And Will Not Furnish Anyone With Information For Changing The Electrical Rating Of Any Appliance Manufactured Or Distributed By Brewmatic Company. Brewmatic will not approve of any unauthorized changes to the basic design of this appliance. Any modification or alteration to the appliance may create a fire hazard, may create a risk of personal injury, may void the safety listings and may void the warranty.

Plumbing connections - All plumbing connections to water supply lines and drains should be performed by a licensed plumber complying with all applicable plumbing codes having jurisdiction.

Electrical connections - With the exception of cords with plugs already attached, all electrical connections or alterations to the power supply should be performed by a licensed electrician complying with all applicable electrical codes having jurisdiction.

When repairing or replacing internal electrical wiring, in part or in whole, use only terminals and wires with the same rating, gauge and insulation covering.

When calling for information, parts or service, have the model number, serial number, voltage, wattage, phase and date of purchase available. Electrical information may be obtained from the electrical information nameplate located on the appliance.

All procedures, diagrams and specifications contained in this manual are based on the latest information available at the time of publication. Information, parts and specifications are subject to change without notice.

We assume no liability for any damage to person or property caused by the utilization of this publication to effect maintenance or repairs.

Due to periodic reviews and changes in safety listing standards, listings and approvals may change at any time. For current listing and approval information contact Brewmatic.

SPECIFICATIONS

Model Number: 9700000

Description: Uno E, Automatic Espresso Machine

Dimensions: 10-1/4" w x 16-3/4" h x 21-1/2" d

Shipping Weight: 75 lbs.

Boiler Capacity: 3.5 Liters

Model Number: 9700014

Description: Uno P, Semi-Automatic Espresso Machine

Dimensions: 10-1/4" w x 16-3/4" h x 21-1/2" d

Shipping Weight: 75 lbs.

Boiler Capacity: 3.5 Liters

Volts: 120

Watts: 1800

Amps: 15

Hertz: 60

Phase: 1

Power Supply Cord: 6 ft, 2 wire + ground. 14 awg.

Plug: NEMA 5-15P. Furnished and attached.

Power Supply Required: 120 volt, 15 amp, dedicated circuit.

Receptacle Required: NEMA 5-15R.

Water Connection: 1/4" flare.

Additional Information:

Boiler Pressure: 1 - 1.4 bar.

Boiler Pressure Adjustment: Pressostat. ⤴ Increase, ⤵ Decrease.

Group Pressure: 6 - 9 bar.

Group Pressure Adjustment: Pump. ⤴ Increase, ⤵ Decrease.

Boiler Fill System: Automatic. Liquid Level Control operated.

PARTS DIAGRAM

Uno E And Uno P

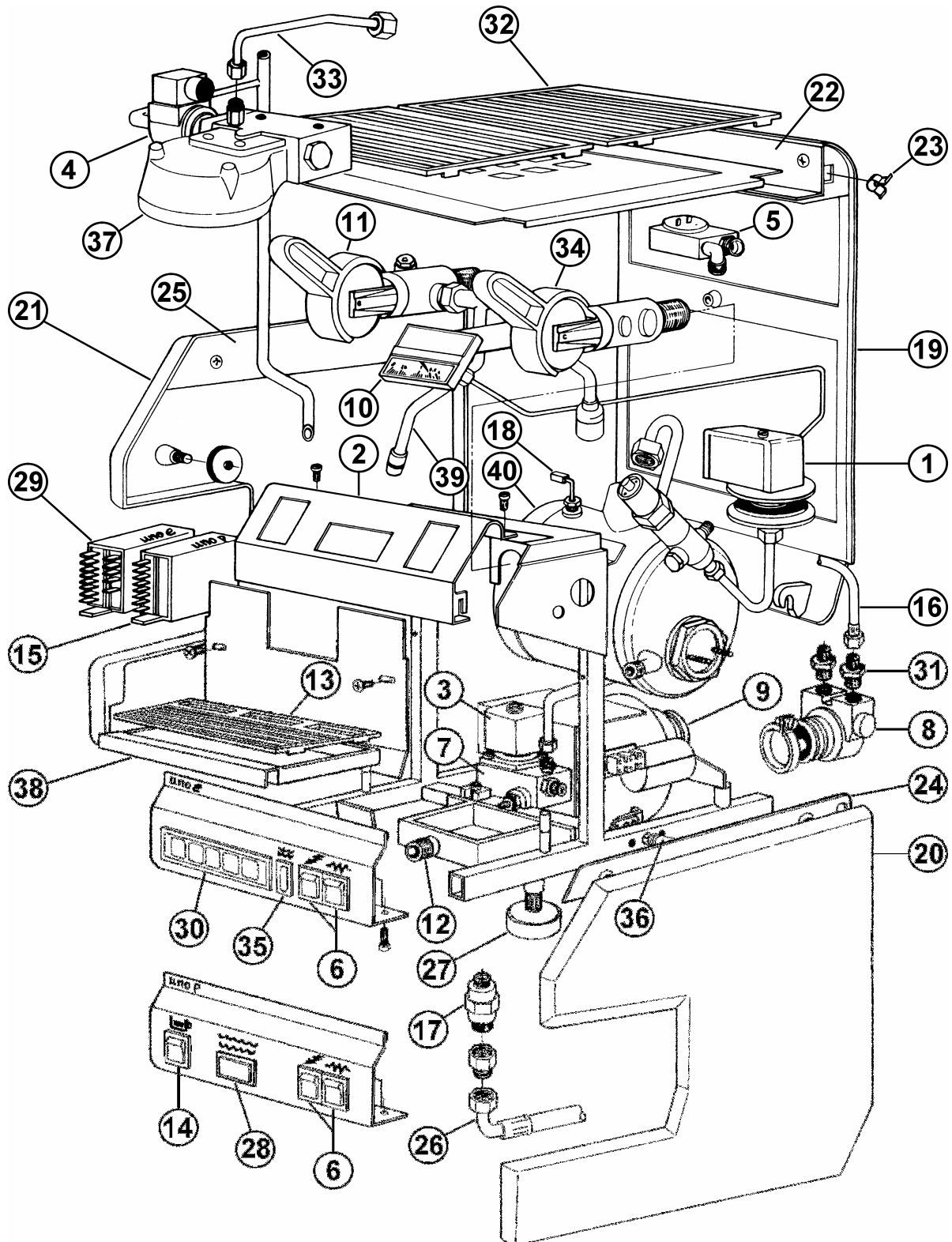

PARTS LIST

Uno E And Uno P

<u>Item</u>	<u>Part No.</u>	<u>Description</u>
1.	9700210	Pressostat
2.	9700211	Panel, Front, Upper, S/S
3.	9700212	Valve, Solenoid, 2-way, 120v
4.	9700213	Valve, Solenoid, 3-Way, 120v
5.	9700219	Flow Meter, (See page 10 for additional information.)
6.	9700228	Switch, Rocker, Clear
7.	9700240	Body, Inlet Valve, (See page 8 for additional information.)
8.	9700241	Pump
9.	9700242	Motor, Pump, 120v
10.	9700274	Gauge, Square, 2 Bar
11.	9700275	Faucet Assy., Steam, (See page 7 for additional information.)
12.	9700277	Tray, Drain, Plastic
13.	9700278	Grid, Drip Tray, Plastic
14.	9700280	Switch, Rocker
15.	9700283	Control, Electronic, 120v, LLC, (Gicar RL30-1E/F) Motor does not come on when filling.
	9700617	Control, Electronic, 120v, LLC, (Gicar RL-1E-2C/F) Motor comes on when filling.
16.	9700286	Hose, Pump, S/S Braided
17.	9700303	Fitting, Water Inlet Assy.
18.	9700308	Probe, Liquid Level, Boiler
19.	9700350	Panel, Back
20.	9700351	Panel, Side, Right
21.	9700352	Panel, Side, Left
22.	9700353	Panel, Seal, Back
23.	9700354	Clip, Spring
24.	9700355	Panel, Seal, Right
25.	9700356	Panel, Seal, Left
26.	9700362	Hose, Water Inlet, S/S Braided
27.	9700442	Foot, Adjustable
28.	9700455	Light, Amber
29.	9700899	Control, Electronic, 120v Control, Electronic, 120v (see wiring schematic on pg 19) (Old # 9700477 Obsolete)
30.	9700478	Switch, Push-Button Panel
31.	9700486	Fitting, Reduction
32.	9700487	Grid, Cup Warming, Plastic
33.	9700519	Tube Assy., Group
34.	9700524	Faucet Assy., Hot Water, (See page 7 for additional information.)
35.	9700554	Light, Amber
36.	9700564	Pin, Mounting, Side
37.	9700689	Group Assy., (See page 6 for additional information.)
38.	9700713	Tray, Drip, S/S
39.	-----	Steam And Water Tubes, (See page 11 for parts information.)
40.	-----	Boiler, (See page 12 for parts information.)

Not Shown:

41.	-----	Filter Holder Assy., (See page 9 for parts information.)
42.	9700363	Contact, 120v
43.	9700479	Wire Harness, 8 Leads, 25 Inches

For a listing of miscellaneous parts and tools see page 13.

PARTS LIST

Group

<u>Item</u>	<u>Part No.</u>	<u>Description</u>
1.	9700519	Tube Assembly, Boiler Heat Exchange To Giggler Fitting
2.	9700387	Screen
3.	9700454	Fitting, Giggler
4.	9700301	Shim, Group Gasket, (Not used on new units. A replacement part only.)
5.	9700215	Gasket, Group
6.	9700218	O-Ring, Spray Head
7.	9700525	Spray Head
8.	9700253	Screw, Spray Head
9.	9700217	Screen
10.	9700254	Screw, Screen
11.	9700414	O-Ring, Valve, (2 required per valve.)
12.	9700302	Electrical Connector, (Wiring not included.)
13.	9700213	Valve, 3 Way, 120v
14.	9700689	Group Body Assy., (With items 3, 6, 7 & 8.)

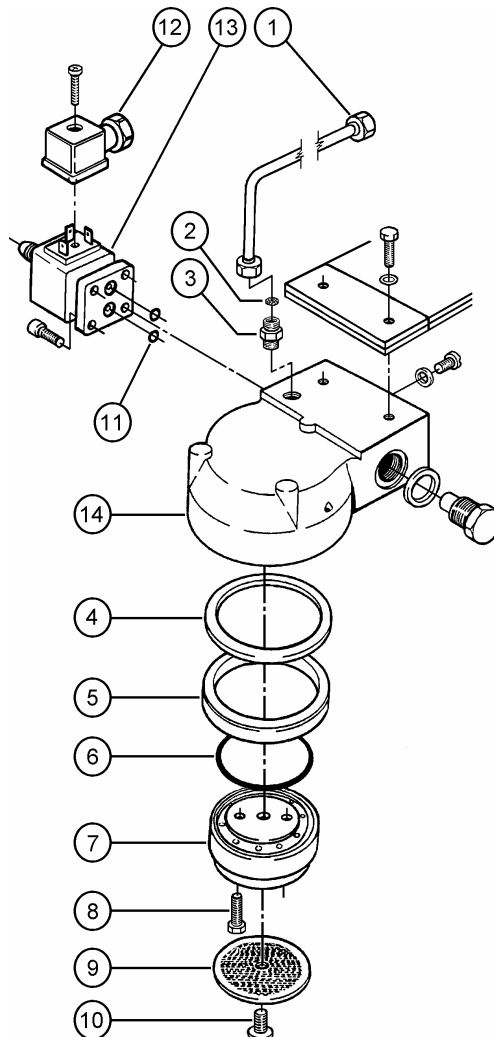

PARTS LIST

Steam And Water Faucets

<u>Item</u>	<u>Part No.</u>	<u>Description</u>
1.	9700605	Nut, Hex
2.	9700434	Fitting, Nipple
3.	9700595	Washer
4.	9700427	Spring
5.	9700220	Stopper, Faucet
6.	9700221	O-Ring
7.	9700604	Stem, Faucet
8.	9700433	Body, Water Faucet
9.	9700432	Body, Steam Faucet
10.	9700257	Anti-Vacuum Valve
11.	9700310	Support, Faucet Handle
12.	9700668	Nut, Hex
13.	9700309	Screw
14.	9700601	Clip
15.	9700602	Pin
16.	9700599	Washer
17.	9700222	Handle, Faucet
18.	9700248	Decal, Water
19.	9700247	Decal, Steam

Also Available

20.	9700275	Faucet Assembly, Steam, (Includes items 1 thru 7, 9 and 10.)
21.	9700524	Faucet Assembly, Water, (Includes items 1 thru 8.)

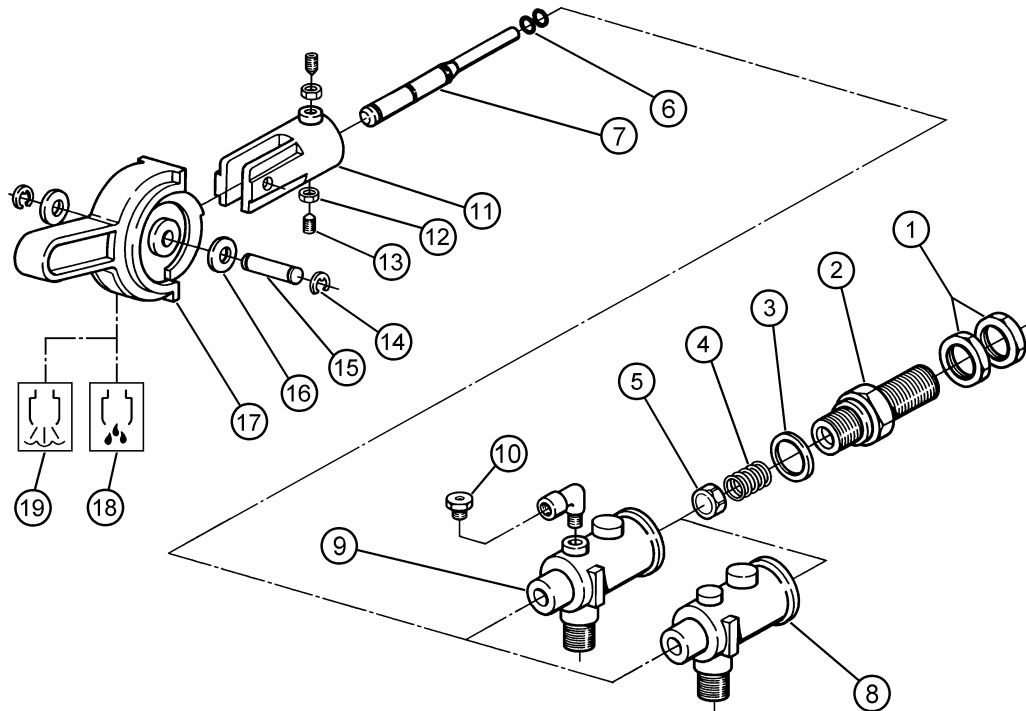

PARTS LIST

Inlet Valve And Valve Body

<u>Item</u>	<u>Part No.</u>	<u>Description</u>
1.	9700548	Cap, 2-Way Valve, (Not required on all 2 way valves.)
2.	9700212	Valve, 2-Way, 120v, (May require a 2-way cap.)
3.	9700414	O-Ring, Valve, (2 required per valve.)
4.	9700472	O-Ring
5.	9700471	O-Ring
6.	9700667	Gasket, Expansion Valve
7.	9700666	Pin, Expansion Valve, (Without gasket.)
8.	9700665	Spring, Expansion Valve
9.	9700664	Screw, Adjustment, Expansion Valve
10.	9700440	O-Ring
11.	9700663	Fitting, Hose
12.	9700538	Fitting, Union, Blind
13.	9700302	Electrical Connector, (Wiring not included.)

Also Available

- | | | |
|-----|---------|---|
| 14. | 9700240 | Valve Body Assembly, Complete,
(Does not includes items 1, 2, 3, 10, 11, 12 & 13.) |
|-----|---------|---|

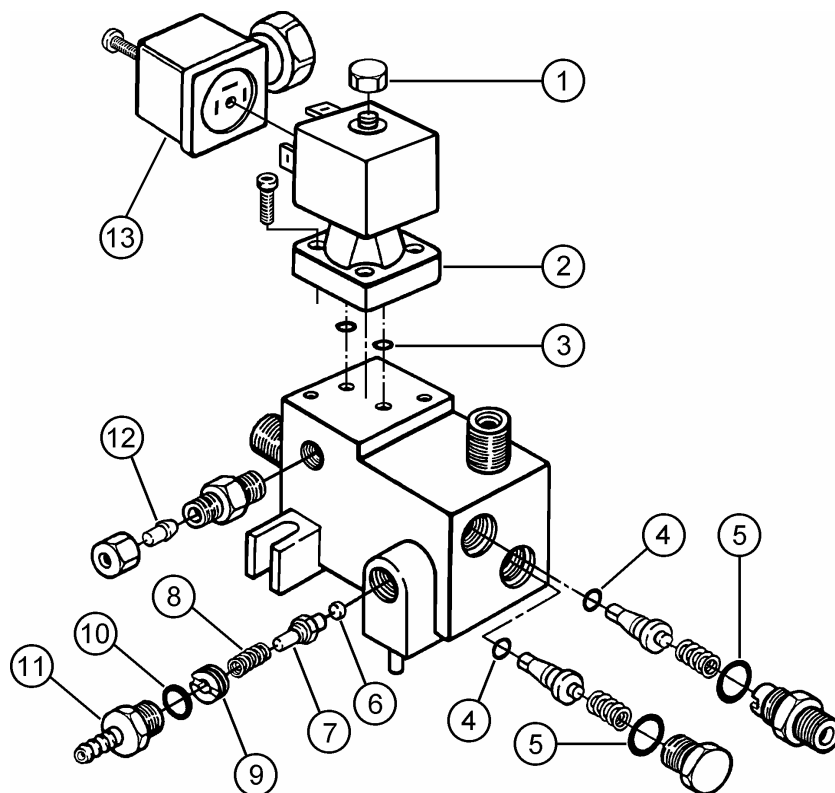

PARTS LIST

Filter Holder

<u>Item</u>	<u>Part No.</u>	<u>Description</u>
1.	9700298	Handle, Filter Holder
2.	9700475	Body, Filter Holder
3.	9700230	Filter, 7 Gram, (Standard)
4.	9700231	Filter, 14 Gram, (Standard)
5.	9700232	Spring
6.	9700233	Outlet, 1-Way
7.	9700307	Outlet, 1-Way, Lateral
8.	9700386	Outlet, 2-Way
9.	9700234	Outlet, 2-Way, With Shield
	9700917	Outlet, 2-Way, With Shield

Also Available

10.	9700236	Filter Holder, (Items 1 & 2 assembled.)
11.	9700412	Filter Holder Assembly, Single, (With items 1, 2, 3, 5 & 6.)
12.	9700413	Filter Holder Assembly, Double, (With items 1, 2, 4, 5 & 9.)